

DIMENSION (UNIT : mm)

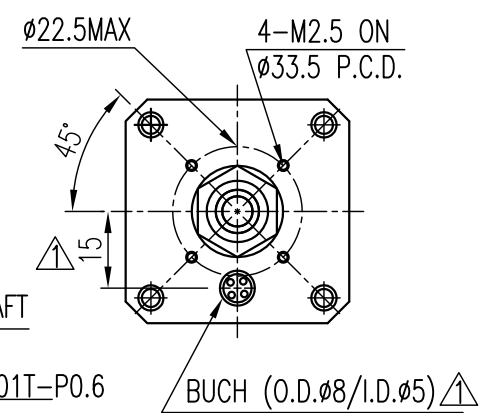
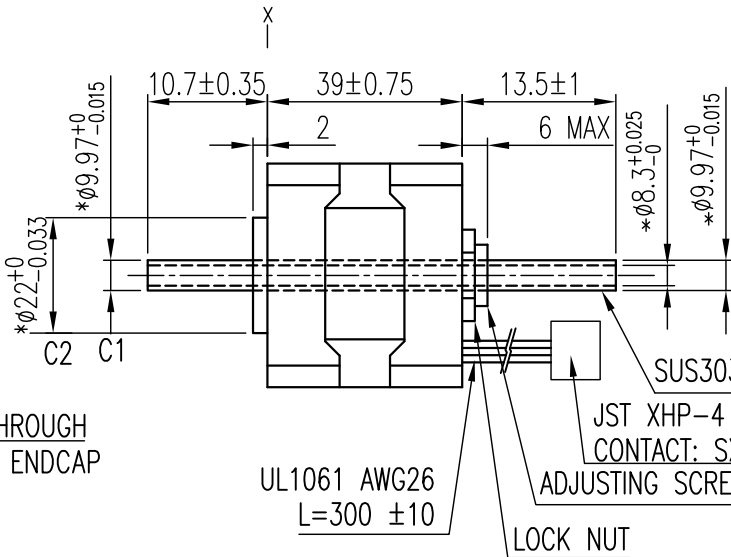
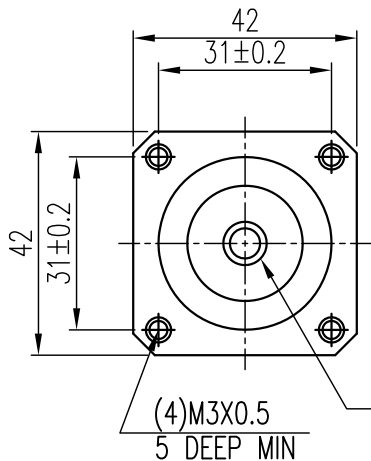

NOTES:

1. C1 DIAMETER RUNOUT TO BE 0.05 mm MAX.
2. C2 CONCENTRIC TO C1 W/IN 0.05 mm TIR.
3. X SURFACE PERPENDICULAR TO C1 W/IN 0.127 mm.
4. END CAPS TO BE BLACK PAINTED.
5. END PLAY : 0.1 MAX. WITH 9.0kg LOAD.
6. TORQUE ADJUSTING SCREW TO 1.44 kg-cm (REF) TO MEET NOTE 5.
7. TORQUE LOCKNUT TO 10.8~14.4 kg-cm.
8. * MEANS IMPORTANT ITEM.

PIN NO.	LEADS
1	WHT
2	RED
3	BLU
4	YEL

SPECIFICATION	
RATED VOLTAGE (VM)DC	1.7
AMPS/PHASE	1.4
RESISTANCE /PHASE Rm (Ohms) @25°C	1.21 ±10% *
INDUCTANCE/PHASE.mH @1KHz	2.1 ±20% *
STEP ANGLE (DEG)	1.8
STEP ACCURACY (NON-ACCUM)	±5%
HOLDING TORQUE (Kg-cm) @1.4A/φ,2φ-Ex.	2.1 *
ROTOR INERTIA (g-cm ²)	54
WEIGHT (g)	250
INSULATION CLASS	B
INSULATION RESISTANCE	100M ohm @500VDC
DIELECTRIC STRENGTH	500VAC FOR ONE MINUTE
AMBIENT TEMPERATURE	-10°C ~ +50°C

FULL STEP 2 PHASE-Ex.,
WHEN FACING MOUNTING END (X)

STEP	A	B	A'	B'	CCW
1	+	+	-	-	↑ ↓ ↑
2	-	+	+	-	
3	-	-	+	+	
4	+	-	-	+	

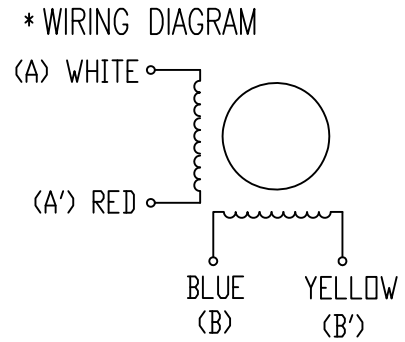

3	UNIT OF HOLDING TORQUE	23.08.10	J.W.	NANOTEC : ST4218M1404-LC-NEU	SCALE FREE	APVD	14.12.04	STEPPING MOTOR
2	PIN-ASSIGNMENT ADD.	16.05.08	J.W.		X ±0.5	CHKD		
1	NEW BUCH	28.11.07	J.W.		1PL ±0.2	DRN		
REV	DESCRIPTION	Datum	APVD		2PL ±0.1	SIGNATURE		
					ANGLE ±30'	DATE		DWG.NO ST4218M1404-LC-NEU