

Front view and mounting

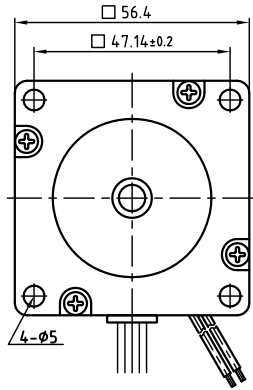

Side view

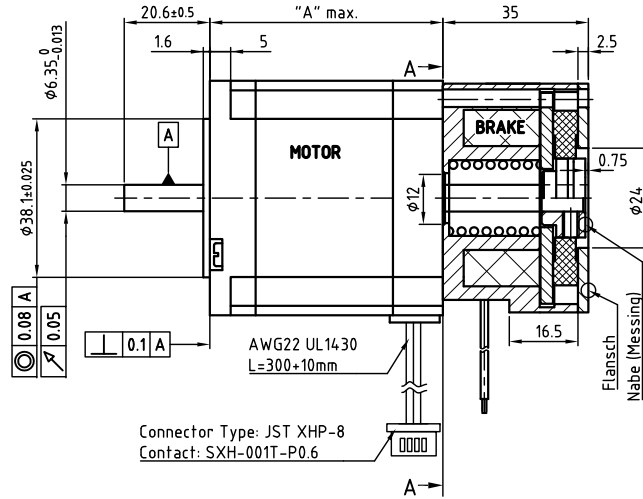

Rear view

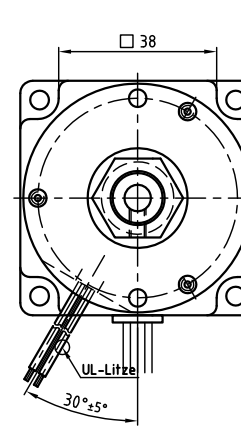

A - A

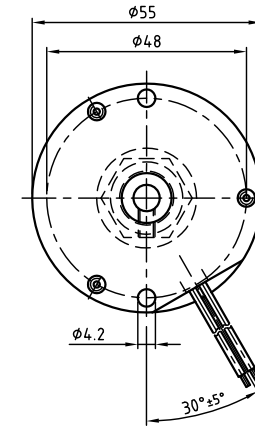

STEPPING MOTOR TYPE	UNIPOLAR OR BIPOLAR 1-WINDING					BRAKE BW-1.4-6.3 (10W)
	OTHER WINDINGS SEE DATESHEETS OR www.nanotec.de					
SPECIFICATION	ST5918X3008	ST5918S3008	ST5918M3008	ST5918L3008	ST5918D4208	
VOLTAGE (VDC)	1.5	2.16	2.1	3.0	4.2	24 Vdc
AMPS/PHASE	3.0	3.0	3.0	3.0	4.2	0.42
RESISTANCE/PHASE (Ohms)@25°C	0.5±15%	0.72±15%	0.7±15%	1.0±15%	1.0±15%	57±10%
INDUCTANCE/PHASE (mH) @1KHz	0.54±20%	1.1±20%	1.3±20%	2.2±20%	2.6±20%	
HOLDING TORQUE (Nm) [lb-in]	0.38 [3.363]	0.65 [5.75]	0.8 [7.08]	1.4 [12.39]	1.8 [15.93]	Mstat: 1.4 [12.39]
DETENT TORQUE (Nm) [lb-in]	0.0147 [0.13]	0.03 [0.266]	0.04 [0.354]	0.068 [0.602]	0.09 [0.797]	
STEP ANGLE (°) ACCURACY (NON-ACCUM)	1.8±5%					SWITCH ON TIME: 20ms
MOTOR LENGTH "A" (mm) [in]	41 [1.61]	51 [2.01]	56 [2.2]	76 [3.0]	115 [4.53]	SWITCH OFF TIME: 18ms
ROTOR INERTIA (Kg-m ²) [lb-in ²]	1.35x10 ⁻⁵ [0.046]	2.75x10 ⁻⁵ [0.094]	3.0x10 ⁻⁵ [0.102]	4.8x10 ⁻⁵ [0.164]	6.5x10 ⁻⁵ [0.222]	1.0x10 ⁻⁵ [3.4x10 ⁻³]
WEIGHT (Kg) [lb]	0.49 [1.08]	0.65 [1.43]	0.7 [1.54]	1.0 [2.2]	1.8 [3.97]	0.4 [0.88]
TEMPERATURE RISE: MAX.80°C (MOTOR STANDSTILL; FOR 2 PHASE ENERGIZED)						
AMBIENT TEMPERATURE -10°~ 50°C [14°F ~ 122°F]						
INSULATION RESISTANCE 100 MOhm (UNDER NORMAL TEMPERATURE AND HUMIDITY)						
INSULATION CLASS B 130° [266°F]						
DIELECTRIC STRENGTH 500VAC FOR 1 MIN. (BETWEEN THE MOTOR COILS AND THE MOTOR CASE)						
AMBIENT HUMIDITY MAX. 85% (NO CONDENSATION)						

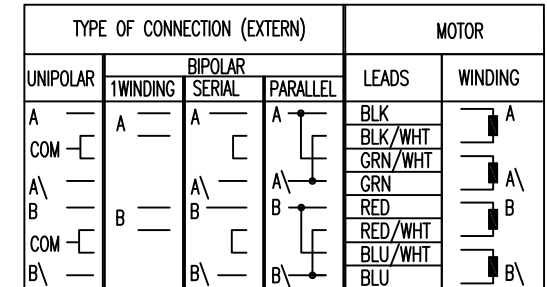

FULL STEP 2 PHASE-Ex., WHEN FACING MOUNTING END (X)

STEP	A	B	A\	B\	CCW	CW
1	+	+	-	-	↓	↑
2	-	+	+	-	↑	↓
3	-	-	+	+	↓	↑
4	+	-	-	+	↑	↓

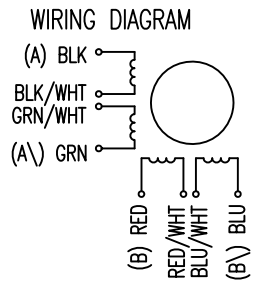

REV	DESCRIPTION	DATE	APVD

Nanotec
PLUG & DRIVE

ST5918+BRAKE

SCALE FREE	APVD	
X ±0.5	CHKD	
1PL ±0.2	DRN	J.W.
2PL ±0.1	SIGNATURE	29.06.09
ANGLE ±30'	DATE	

STEPPING MOTOR

DWG.NO ST5918+BRAKE